

SEPA Rules - WAC 197-11-970
Mitigated Determination of Non-Significance (MDNS)
Clallam County Public Utility District
Forks Service Center

Project

Proponent: Clallam County Public Utility District No. 1 (PUD)
P.O. Box 1000
Carlsborg, WA 98324
Attn: Mike Hill

Description

of proposal: Two phase project that would create two larger buildings with the first phase being the construction of an equipment and vehicle storage building (Equipment Building) that would be 7,882 sq. ft with associated paving and gravel parking surfaces. The first phase would be built during 2016-2017. The second phase would be the construction of an Operations Center that would be 9,246 sq. ft and would be constructed in 2021-2022. The Equipment Building will consist of nine vehicle bays and a maintenance shop. Septic system designed for 15 people will be used to address wastewater needs. PUD will include in the project a generator utilizing an above ground fuel storage tank.

Location of

Property: 241 Industrial Center, Forks, WA (Forks Industrial Park north of the MASCO Office).

Description

Property: Parcel 4 of Survey recorded at Vol. 20, Pg. 24 and being a portion of the SE ¼ of Section 32, T 29 N, R 13 W, Clallam County, WA
Tax Id. No. 132932400400

Lead Agency Rod Fleck, City Attorney/Planner
City of Forks
500 East Division
Forks, Washington 98331

Proposed

Project: Construction of a PUD service center with the first phase of the construction consisting of grading the existing site, graveling areas to store equipment and vehicles, and construction of a 7,882 sq. ft vehicle and equipment building. Site improvement will require the excavating of approximately 10,000 cubic yards of material, and then the placement of 8,000 cubic yards of gravel and other fill materials needed to construct the project. Asphalt for parking and other purposes will be constructed adjacent to the building's north and south sides. The building will consist of nine bays for vehicle storage and a service/maintenance bay to be used for vehicular and equipment repair. The PUD will be installing an on-site septic system designed for fifteen people. In addition, the building will host a generator and an above-ground fuel storage tank. Finally, the PUD would fence the property and install security access points. Phase I would be undertaken in 2016 and 2017.

Phase II would be the construction of an operations center consisting of the construction of a 9,246 sq. ft operations center. This facility is proposed for construction in 2021-2022 and will consist offices, ready room, lockers, lunch room, bays for parking five trucks and

covered storage for materials and parts. This building would utilize the same septic system installed for the first vehicle storage and equipment building in Phase I. Upon completion of Phase I, 7% of the 4.8 acre lot will consist of impervious surfaces with that number rising to 50% at the conclusion of Phase II.

Prior SEPA

Documents: None associated with this proposal.

Mitigation required:

1. Applicant will be required to obtain a special use permit for the construction of the public buildings associated with this SEPA determination. This determination will become part of the requirements associated with that permit.
2. Applicant will obtain a grading permit from the City of Forks prior to undertaking grading.
3. Applicant will be required to obtain a building permit, subject to plan review by a 3rd party reviewer, from the City of Forks Building Inspector prior to construction.
4. Applicant is also given notice that they may be required to obtain a common plat related NDPES permit from the Department of Ecology for a common plan of development and the associated stormwater issues associated with that development. This permit is granted and enforced solely by the Department of Ecology. Additional information could be obtained from DOE's Joyce Smith 360/407-6858.
5. Ensure that the awarded Contractor has a contractual requirement that requires immediate notification by the Contractor, or any subcontractors, and their employees upon discovering any archaeological resource(s), as well as, any discovery of human remains. Notification protocol shall include the District, the City of Forks (Forks Police Department and City Attorney's Office), the Quileute Tribal Council, and DAHP. Said protocol shall include stop work provisions, as well as penalty provisions if not followed by the Contractor and/or their subcontractors.
6. Applicant will ensure that excavated materials from the site is either recycled and used at the project; or, properly disposed of in accordance with local, state and/or federal laws. Also, Applicant noted the existence of scotch broom and in the removal of the excavated spoils, if being disposed of an offsite location, Applicant will ensure the disposal site is one accepting spoils with scotch broom.
7. All stormwater drainage must be constructed to ensure that:
 - a. it is kept on site;
 - b. the drainage system is registered by the PUD in accordance with the Department of Ecology's injection well registration requirements; and,
 - c. that the drainage system is reviewed by the Building Inspector prior to construction.
8. Access from the City street will require a driveway permit and the construction of that access will be in accordance with specifications reviewed and approved with
9. Construction will occur during the period of time permitted by the City's existing noise ordinance.
10. Storage and operations associated with the maintenance of vehicles must comply with all applicable federal and state regulations. Further, indication of the potential storage of flammable materials needs to be incorporated into the building in the case that there is ever a fire at that location.
11. Above-ground fuel storage tank must be installed in a manner that complies with federal and state regulations.

12. Septic system may require the site be registered with Clallam County's Department of Environmental Health. Applicant will ensure such requirement is addressed, if applicable, as part of the septic system permitting process required by that same County Department. Applicant will be required to submit a copy of the septic permit with their building permit application to the City of Forks.
13. All utility connections must be done pursuant to the utility providers' requirements in a manner that meets local, state and/or federal code requirements.
14. Buildings will comply with existing legal requirements to address public access under the Americans with Disabilities Act.
15. Exterior lighting of the building will be installed in such a way to ensure that lighting is captured on the surface of the building.
16. Construction of the Operations Center may require a revision to this SEPA MDNS at the time of construction. Applicant will be required to meet with the City's officials as part of the planning process for that building. In addition, if no revision of the SEPA is required, Applicant may be required to seek review of the on-site septic system by the County's Department of Environmental Health to determine if at the time of Phase II construction the Phase I septic system can be utilized in the manner envisioned in this application.

The Lead Agency has determined that the above items do not have a probable significant adverse impact based upon the proposed mitigation required above. An environmental impact statement (EIS) is not required under RCW 43.21C.030(2). This decision was made after review of a complete environmental checklist and other information on file with the lead agency. This information is available to the public on request.

This MDNS is issued under 197-11-340 (2); the lead agency will not act on this proposal for a period of 14 days from the date of issuance to allow for agency review and comment, as well as comments from the general public. Comments must be submitted to the City Planner at:

Rod Fleck, City Attorney/Planner
Forks City Hall
500 East Division
Forks, Washington 98331

Comments will be accepted up to 5 p.m., 18 Jul 2016. The City will review said comments together to determine the impact upon the stated MDNS. Submittal of comments is not the same as a written appeal of this determination, or asserting lead agency status. The City may not issue any other determination if the review of the comments does not alter the stated MDNS.

You may appeal this determination no later than noon, 18 Jul 2016, by filing a written appeal with the City Clerk of Forks at 500 East Division, Forks, Washington 98331. You should be prepared to make specific factual objections. The appeal must be received prior to 5 P.M. Contact Rod Fleck at 360/374-5412, ext. 245 to read or ask about the procedures for appeals.

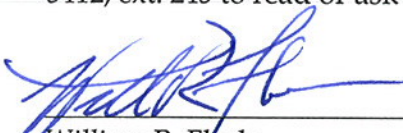

William R. Fleck
Attorney/Planner

Date: 29 June 2016

SEPA ENVIRONMENTAL CHECKLIST

Purpose of checklist:

Governmental agencies use this checklist to help determine whether the environmental impacts of your proposal are significant. This information is also helpful to determine if available avoidance, minimization or compensatory mitigation measures will address the probable significant impacts or if an environmental impact statement will be prepared to further analyze the proposal.

Instructions for applicants:

This environmental checklist asks you to describe some basic information about your proposal. Please answer each question accurately and carefully, to the best of your knowledge. You may need to consult with an agency specialist or private consultant for some questions. You may use "not applicable" or "does not apply" only when you can explain why it does not apply and not when the answer is unknown. You may also attach or incorporate by reference additional studies reports. Complete and accurate answers to these questions often avoid delays with the SEPA process as well as later in the decision-making process.

The checklist questions apply to all parts of your proposal, even if you plan to do them over a period of time or on different parcels of land. Attach any additional information that will help describe your proposal or its environmental effects. The agency to which you submit this checklist may ask you to explain your answers or provide additional information reasonably related to determining if there may be significant adverse impact.

Instructions for Lead Agencies:

Please adjust the format of this template as needed. Additional information may be necessary to evaluate the existing environment, all interrelated aspects of the proposal and an analysis of adverse impacts. The checklist is considered the first but not necessarily the only source of information needed to make an adequate threshold determination. Once a threshold determination is made, the lead agency is responsible for the completeness and accuracy of the checklist and other supporting documents.

Use of checklist for nonproject proposals: [\[help\]](#)

For nonproject proposals (such as ordinances, regulations, plans and programs), complete the applicable parts of sections A and B plus the SUPPLEMENTAL SHEET FOR NONPROJECT ACTIONS (part D). Please completely answer all questions that apply and note that the words "project," "applicant," and "property or site" should be read as "proposal," "proponent," and "affected geographic area," respectively. The lead agency may exclude (for non-projects) questions in Part B - Environmental Elements –that do not contribute meaningfully to the analysis of the proposal.

A. Background [\[help\]](#)

1. Name of proposed project, if applicable: [\[help\]](#)

Forks Service Center to be located at 241 Industrial Center, Forks WA.

2. Name of applicant: [\[help\]](#)

Clallam County PUD #1

3. Address and phone number of applicant and contact person: [\[help\]](#)

P.O. Box 1000, Carlsborg WA 98324. Contact: Mike Hill 360-565-3286,
mikeh@clallampud.net

3. Date checklist prepared: [\[help\]](#)

5-31-16

5. Agency requesting checklist: [\[help\]](#)

Clallam County

6. Proposed timing or schedule (including phasing, if applicable): [\[help\]](#)

Phase 1: Equipment Building 2016-17

Phase 2: Operations Center 2021-22

7. Do you have any plans for future additions, expansion, or further activity related to or connected with this proposal? If yes, explain. [\[help\]](#)

No

8. List any environmental information you know about that has been prepared, or will be prepared, directly related to this proposal. [\[help\]](#)

None

9. Do you know whether applications are pending for governmental approvals of other proposals directly affecting the property covered by your proposal? If yes, explain. [\[help\]](#)

No

10. List any government approvals or permits that will be needed for your proposal, if known. [\[help\]](#)

City of Forks building permit

11. Give brief, complete description of your proposal, including the proposed uses and the size of the project and site. There are several questions later in this checklist that ask you to describe certain aspects of your proposal. You do not need to repeat those answers on this page. (Lead agencies may modify this form to include additional specific information on project description.) [\[help\]](#)

Phase 1: Build a 7,882 Square foot 9 bay, equipment and storage building,
install 13,364 square feet of asphalt and 113,255 square feet of gravel surface.

Phase 2: Build a 9,246 Square foot Operations Center

12. Location of the proposal. Give sufficient information for a person to understand the precise location of your proposed project, including a street address, if any, and section, township, and range, if known. If a proposal would occur over a range of area, provide the range or boundaries of the site(s). Provide a legal description, site plan, vicinity map, and topographic map, if reasonably available. While you should submit any plans required by the agency, you

are not required to duplicate maps or detailed plans submitted with any permit applications related to this checklist. [\[help\]](#)

241 Industrial Center, Forks, WA 98331
Parcel 4 of Survey Volume 20, Page 24
Portion of the SE ¼ of S. 32 T29N, R13W, WM

B. ENVIRONMENTAL ELEMENTS [\[help\]](#)

1. Earth [\[help\]](#)

a. General description of the site: [\[help\]](#)

(circle one): Flat, rolling, hilly, steep slopes, mountainous, other _____ Flat _____

b. What is the steepest slope on the site (approximate percent slope)? [\[help\]](#)

5%

c. What general types of soils are found on the site (for example, clay, sand, gravel, peat, muck)? If you know the classification of agricultural soils, specify them and note any agricultural land of long-term commercial significance and whether the proposal results in removing any of these soils. [\[help\]](#)

Gravels

d. Are there surface indications or history of unstable soils in the immediate vicinity? If so, describe. [\[help\]](#)

No

e. Describe the purpose, type, total area, and approximate quantities and total affected area of any filling, excavation, and grading proposed. Indicate source of fill. [\[help\]](#)

Excavation and fill on the site will be to level the site, create a stable roadway section, create positive drainage away from building and towards stormwater facilities. Some excavation will be required for the installation of stormwater detention and/or infiltration facilities. Total area of the excavation is approximately 4.8 ac. There will be approximately 10,000 c.y. of excavation/export and 8,000 c.y. of fill/import. Import material will primarily consist of gravel base and crushed surfacing materials for roadway/parking area construction.

f. Could erosion occur as a result of clearing, construction, or use? If so, generally describe. [\[help\]](#)

Yes. Construction activities such as clearing and grubbing, excavation, and grading will expose soils to erosion from stormwater runoff. Final condition of the site

could lead to an increase in erosion due to increased runoff quantity and velocity from hard surfaces such as roofs and roadway areas.

g. About what percent of the site will be covered with impervious surfaces after project construction (for example, asphalt or buildings)? [\[help\]](#)

Phase 1: 7.7%

Phase 2: 50%

h. Proposed measures to reduce or control erosion, or other impacts to the earth, if any: [\[help\]](#)

Engineered Drainage Plan

2. Air [\[help\]](#)

a. What types of emissions to the air would result from the proposal during construction, operation, and maintenance when the project is completed? If any, generally describe and give approximate quantities if known. [\[help\]](#)

Minimal, typical building construction

b. Are there any off-site sources of emissions or odor that may affect your proposal? If so, generally describe. [\[help\]](#)

No

c. Proposed measures to reduce or control emissions or other impacts to air, if any: [\[help\]](#)

None

3. Water [\[help\]](#)

a. Surface Water:

1) Is there any surface water body on or in the immediate vicinity of the site (including year-round and seasonal streams, saltwater, lakes, ponds, wetlands)? If yes, describe type and provide names. If appropriate, state what stream or river it flows into. [\[help\]](#)

No

2) Will the project require any work over, in, or adjacent to (within 200 feet) the described waters? If yes, please describe and attach available plans. [\[help\]](#)

N/A

3) Estimate the amount of fill and dredge material that would be placed in or removed from surface water or wetlands and indicate the area of the site that would be affected. Indicate the source of fill material. [\[help\]](#)

None

4) Will the proposal require surface water withdrawals or diversions? Give general description, purpose, and approximate quantities if known. [\[help\]](#)

No

5) Does the proposal lie within a 100-year floodplain? If so, note location on the site plan. [\[help\]](#)

No

6) Does the proposal involve any discharges of waste materials to surface waters? If so, describe the type of waste and anticipated volume of discharge. [\[help\]](#)

No

b. Ground Water:

1) Will groundwater be withdrawn from a well for drinking water or other purposes? If so, give a general description of the well, proposed uses and approximate quantities withdrawn from the well. Will water be discharged to groundwater? Give general description, purpose, and approximate quantities if known. [\[help\]](#)

No

2) Describe waste material that will be discharged into the ground from septic tanks or other sources, if any (for example: Domestic sewage; industrial, containing the following chemicals. . . ; agricultural; etc.). Describe the general size of the system, the number of such systems, the number of houses to be served (if applicable), or the number of animals or humans the system(s) are expected to serve. [\[help\]](#)

Onsite sewage for approximately 15 workers

c. Water runoff (including stormwater):

1) Describe the source of runoff (including storm water) and method of collection and disposal, if any (include quantities, if known). Where will this water flow? Will this water flow into other waters? If so, describe. [\[help\]](#)

Onsite engineered stormwater plan will be submitted that includes a stormwater detention pond.

2) Could waste materials enter ground or surface waters? If so, generally describe. [\[help\]](#)

No

3) Does the proposal alter or otherwise affect drainage patterns in the vicinity of the site? If so, describe. [\[help\]](#)

No

d. Proposed measures to reduce or control surface, ground, and runoff water, and drainage pattern impacts, if any: [\[help\]](#)

Onsite engineered stormwater plan will be submitted that includes a stormwater detention pond.

4. **Plants** [\[help\]](#)

a. Check the types of vegetation found on the site: [\[help\]](#)

deciduous tree: alder, maple, aspen, other

evergreen tree: fir, cedar, pine, other

shrubs

grass

pasture

crop or grain

Orchards, vineyards or other permanent crops.

wet soil plants: cattail, buttercup, bullrush, skunk cabbage, other

water plants: water lily, eelgrass, milfoil, other

other types of vegetation

b. What kind and amount of vegetation will be removed or altered? [\[help\]](#)

Grass

c. List threatened and endangered species known to be on or near the site. [\[help\]](#)

None known

d. Proposed landscaping, use of native plants, or other measures to preserve or enhance vegetation on the site, if any: [\[help\]](#)

Retain existing westerly tree buffer.

e. List all noxious weeds and invasive species known to be on or near the site. [\[help\]](#)

Scotchbroom

5. **Animals** [\[help\]](#)

a. List any birds and other animals which have been observed on or near the site or are known to be on or near the site. [\[help\]](#)

Examples include:

birds: hawk, heron, eagle, songbirds, other:

mammals: deer, bear, elk, beaver, other:

fish: bass, salmon, trout, herring, shellfish, other deer, elk, songbirds

b. List any threatened and endangered species known to be on or near the site. [\[help\]](#)
None known

c. Is the site part of a migration route? If so, explain. [\[help\]](#)
No

d. Proposed measures to preserve or enhance wildlife, if any: [\[help\]](#)
None

e. List any invasive animal species known to be on or near the site. [\[help\]](#)
None known

6. Energy and Natural Resources [\[help\]](#)

a. What kinds of energy (electric, natural gas, oil, wood stove, solar) will be used to meet the completed project's energy needs? Describe whether it will be used for heating, manufacturing, etc. [\[help\]](#)

Electric for heating and lighting.

b. Would your project affect the potential use of solar energy by adjacent properties? If so, generally describe. [\[help\]](#)
No

c. What kinds of energy conservation features are included in the plans of this proposal? List other proposed measures to reduce or control energy impacts, if any: [\[help\]](#)
Lighting and Heat Pumps

7. Environmental Health [\[help\]](#)

a. Are there any environmental health hazards, including exposure to toxic chemicals, risk of fire and explosion, spill, or hazardous waste, that could occur as a result of this proposal? If so, describe. [\[help\]](#)

1) Describe any known or possible contamination at the site from present or past uses.
[\[help\]](#) None known

2) Describe existing hazardous chemicals/conditions that might affect project development and design. This includes underground hazardous liquid and gas transmission pipelines located within the project area and in the vicinity. [\[help\]](#)
None

3) Describe any toxic or hazardous chemicals that might be stored, used, or produced during the project's development or construction, or at any time during the operating life of the project. [\[help\]](#)

Propane or Diesel tank for standby generator

4) Describe special emergency services that might be required. [\[help\]](#)
None

5) Proposed measures to reduce or control environmental health hazards, if any: [\[help\]](#)
None

b. Noise [\[help\]](#)

1) What types of noise exist in the area which may affect your project (for example: traffic, equipment, operation, other)? [\[help\]](#)

Highway Traffic

2) What types and levels of noise would be created by or associated with the project on a short-term or a long-term basis (for example: traffic, construction, operation, other)?
Indicate what hours noise would come from the site. [\[help\]](#)

Normal construction noise in the short term

3) Proposed measures to reduce or control noise impacts, if any: [\[help\]](#)
None

8. Land and Shoreline Use [\[help\]](#)

a. What is the current use of the site and adjacent properties? Will the proposal affect current land uses on nearby or adjacent properties? If so, describe. [\[help\]](#)

The site is currently vacant located in an Industrial Park, with one neighboring property zoned as Commercial Forest. No negative affects to adjacent properties.

b. Has the project site been used as working farmlands or working forest lands? If so, describe. How much agricultural or forest land of long-term commercial significance will be converted to other uses as a result of the proposal, if any? If resource lands have not been designated, how many acres in farmland or forest land tax status will be converted to nonfarm or nonforest use? [\[help\]](#)

No

1) Will the proposal affect or be affected by surrounding working farm or forest land normal business operations, such as oversize equipment access, the application of pesticides, tilling, and harvesting? If so, how: [\[help\]](#)

No

b. Describe any structures on the site. [\[help\]](#)

None

d. Will any structures be demolished? If so, what? [\[help\]](#)

No

e. What is the current zoning classification of the site? [\[help\]](#)

F_IP, Forks Industrial Park

f. What is the current comprehensive plan designation of the site? [\[help\]](#)

Forks

g. If applicable, what is the current shoreline master program designation of the site? [\[help\]](#)

N/A

h. Has any part of the site been classified as a critical area by the city or county? If so, specify. [\[help\]](#)

No

i. Approximately how many people would reside or work in the completed project? [\[help\]](#)

15

j. Approximately how many people would the completed project displace? [\[help\]](#)

None

k. Proposed measures to avoid or reduce displacement impacts, if any: [\[help\]](#)

None

l. Proposed measures to ensure the proposal is compatible with existing and projected land uses and plans, if any: [\[help\]](#)

Project review submittal

m. Proposed measures to ensure the proposal is compatible with nearby agricultural and forest lands of long-term commercial significance, if any: [\[help\]](#)

None

9. Housing [\[help\]](#)

a. Approximately how many units would be provided, if any? Indicate whether high, middle, or low-income housing. [\[help\]](#)

None

- b. Approximately how many units, if any, would be eliminated? Indicate whether high, middle, or low-income housing. [\[help\]](#)

None

- b. Proposed measures to reduce or control housing impacts, if any: [\[help\]](#)

None

10. Aesthetics [\[help\]](#)

- a. What is the tallest height of any proposed structure(s), not including antennas; what is the principal exterior building material(s) proposed? [\[help\]](#)
30', metal siding

- b. What views in the immediate vicinity would be altered or obstructed? [\[help\]](#)

Minimal

- b. Proposed measures to reduce or control aesthetic impacts, if any: [\[help\]](#)

Fencing

11. Light and Glare [\[help\]](#)

- a. What type of light or glare will the proposal produce? What time of day would it mainly occur? [\[help\]](#)
Area flood lights for security

- b. Could light or glare from the finished project be a safety hazard or interfere with views? [\[help\]](#)

No

- c. What existing off-site sources of light or glare may affect your proposal? [\[help\]](#)

No

- d. Proposed measures to reduce or control light and glare impacts, if any: [\[help\]](#)

Light shielding

12. Recreation [\[help\]](#)

- a. What designated and informal recreational opportunities are in the immediate vicinity? [\[help\]](#)

None

- b. Would the proposed project displace any existing recreational uses? If so, describe. [\[help\]](#)

No

- c. Proposed measures to reduce or control impacts on recreation, including recreation opportunities to be provided by the project or applicant, if any: [\[help\]](#)

None

13. Historic and cultural preservation [\[help\]](#)

- a. Are there any buildings, structures, or sites, located on or near the site that are over 45 years old listed in or eligible for listing in national, state, or local preservation registers located on or near the site? If so, specifically describe. [\[help\]](#)

No

- b. Are there any landmarks, features, or other evidence of Indian or historic use or occupation? This may include human burials or old cemeteries. Are there any material evidence, artifacts, or areas of cultural importance on or near the site? Please list any professional studies conducted at the site to identify such resources. [\[help\]](#)

No

- c. Describe the methods used to assess the potential impacts to cultural and historic resources on or near the project site. Examples include consultation with tribes and the department of archeology and historic preservation, archaeological surveys, historic maps, GIS data, etc. [\[help\]](#)

SEPA process

- d. Proposed measures to avoid, minimize, or compensate for loss, changes to, and disturbance to resources. Please include plans for the above and any permits that may be required. [\[help\]](#)

None

14. Transportation [\[help\]](#)

- a. Identify public streets and highways serving the site or affected geographic area and describe proposed access to the existing street system. Show on site plans, if any. [\[help\]](#)

Industrial Center Road, direct access

- b. Is the site or affected geographic area currently served by public transit? If so, generally describe. If not, what is the approximate distance to the nearest transit stop? [\[help\]](#)

Yes, Highway 101

- c. How many additional parking spaces would the completed project or non-project proposal have? How many would the project or proposal eliminate? [\[help\]](#)

15 new parking spaces, none eliminated.

- d. Will the proposal require any new or improvements to existing roads, streets, pedestrian, bicycle or state transportation facilities, not including driveways? If so, generally describe (indicate whether public or private). [\[help\]](#)

No

- e. Will the project or proposal use (or occur in the immediate vicinity of) water, rail, or air transportation? If so, generally describe. [\[help\]](#)

No

- f. How many vehicular trips per day would be generated by the completed project or proposal? If known, indicate when peak volumes would occur and what percentage of the volume would be trucks (such as commercial and nonpassenger vehicles). What data or transportation models were used to make these estimates? [\[help\]](#)

30, peak at 8am and 4:30 pm

- g. Will the proposal interfere with, affect or be affected by the movement of agricultural and forest products on roads or streets in the area? If so, generally describe. [\[help\]](#)

No

- h. Proposed measures to reduce or control transportation impacts, if any: [\[help\]](#)

None

15. Public Services [\[help\]](#)

- a. Would the project result in an increased need for public services (for example: fire protection, police protection, public transit, health care, schools, other)? If so, generally describe. [\[help\]](#)

No

- b. Proposed measures to reduce or control direct impacts on public services, if any. [\[help\]](#)

None

16. Utilities [\[help\]](#)

- a. Circle utilities currently available at the site: [\[help\]](#)
electricity, natural gas, water, refuse service, telephone, sanitary sewer, septic system,
other _electricity, water and telephone_____

- b. Describe the utilities that are proposed for the project, the utility providing the service, and the general construction activities on the site or in the immediate vicinity which might be needed. [\[help\]](#)

Water from City of Forks, Electricity from Clallam County PUD. Utilities are located at the site.

C. Signature [\[help\]](#)

The above answers are true and complete to the best of my knowledge. I understand that the lead agency is relying on them to make its decision.

Signature: _____

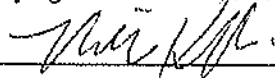

Name of signee Mike Hill
Position and Agency/Organization Transmission Substation Supervisor
Date Submitted: 6-8-16 Clallam County PUD

D. supplemental sheet for nonproject actions [\[help\]](#)

(IT IS NOT NECESSARY to use this sheet for project actions)

Because these questions are very general, it may be helpful to read them in conjunction with the list of the elements of the environment.

When answering these questions, be aware of the extent the proposal, or the types of activities likely to result from the proposal, would affect the item at a greater intensity or at a faster rate than if the proposal were not implemented. Respond briefly and in general terms.

1. How would the proposal be likely to increase discharge to water; emissions to air; production, storage, or release of toxic or hazardous substances; or production of noise?

Proposed measures to avoid or reduce such increases are:

2. How would the proposal be likely to affect plants, animals, fish, or marine life?

Proposed measures to protect or conserve plants, animals, fish, or marine life are:

3. How would the proposal be likely to deplete energy or natural resources?

Proposed measures to protect or conserve energy and natural resources are:

4. How would the proposal be likely to use or affect environmentally sensitive areas or areas designated (or eligible or under study) for governmental protection; such as parks, wilderness, wild and scenic rivers, threatened or endangered species habitat, historic or cultural sites, wetlands, floodplains, or prime farmlands?

Proposed measures to protect such resources or to avoid or reduce impacts are:

5. How would the proposal be likely to affect land and shoreline use, including whether it would allow or encourage land or shoreline uses incompatible with existing plans?

Proposed measures to avoid or reduce shoreline and land use impacts are:

6. How would the proposal be likely to increase demands on transportation or public services and utilities?

Proposed measures to reduce or respond to such demand(s) are:

7. Identify, if possible, whether the proposal may conflict with local, state, or federal laws or requirements for the protection of the environment.

VEHICLE STORAGE BUILDING AREA: 7,882 SF

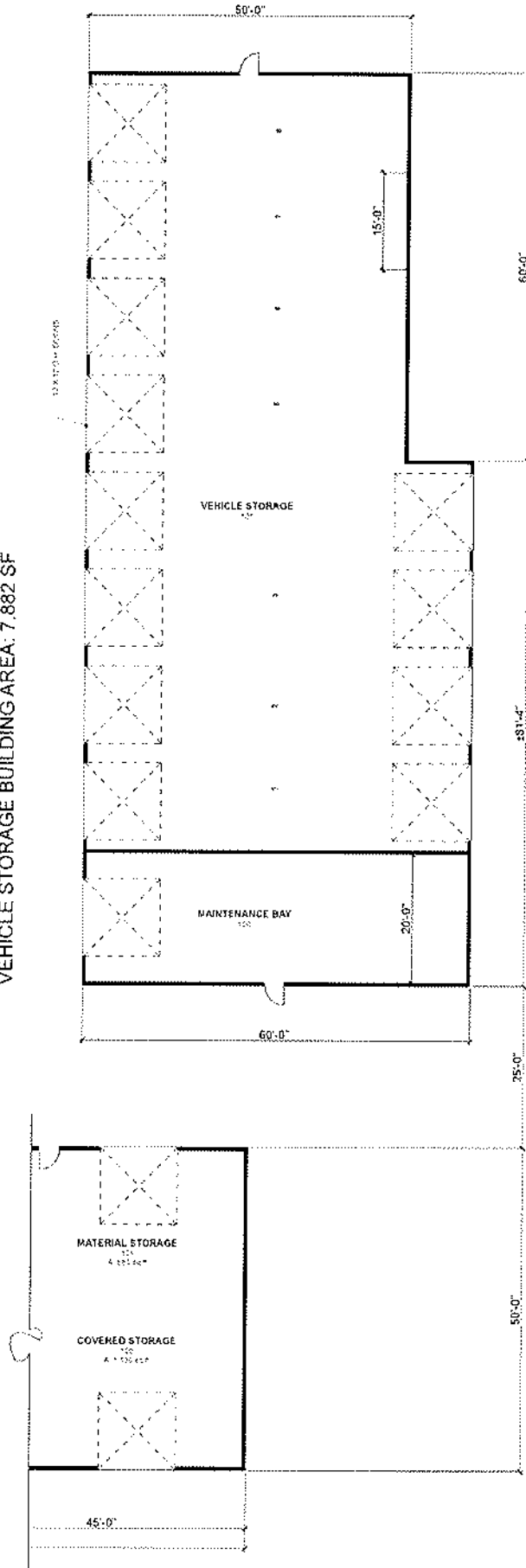

VEHICLE & EQUIPMENT STORAGE FLOOR PLAN

REF:

1/16" = 1'-0"

1/7/14

A2-2

CLALLAM CO. PUD #1

Forks Operations Center

15-01

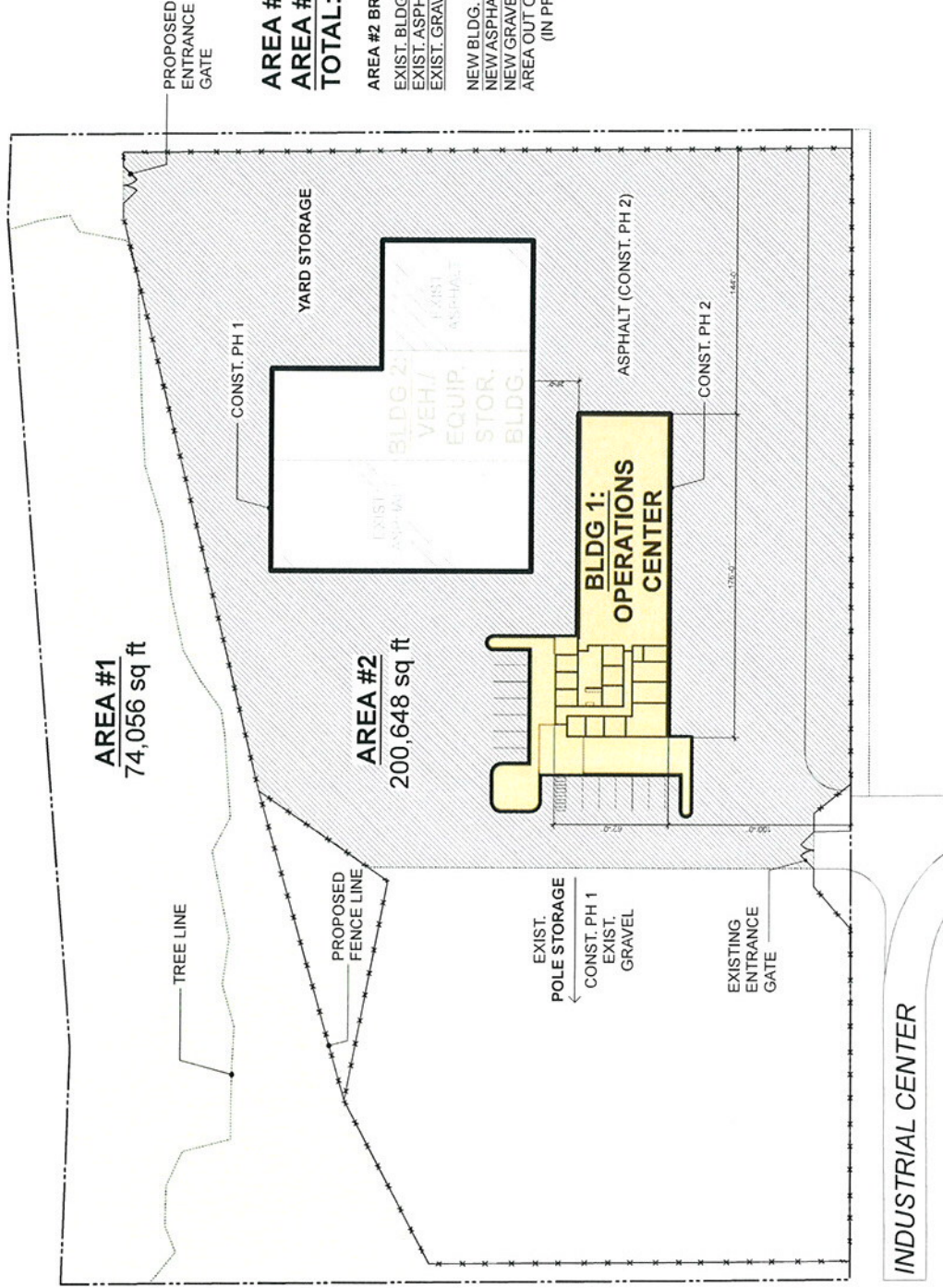

AREA #1: 74,056 SF
AREA #2: 200,648 SF
TOTAL: 274,944 SF

AREA #2 BREAKDOWN:

EXIST. BLDG.:	7,882 SF
EXIST. ASPHALT:	13,364 SF
EXIST. GRAVEL:	48,445 SF
NEW BLDG. / LANDSCAPE:	12,740 SF
NEW ASPHALT:	104,248 SF
NEW GRAVEL:	6,516 SF
AREA OUT OF FENCE:	7,451 SF

(IN PROP LINE)



1" = 60'
 1/22/16

A1-1

CONSTRUCTION PHASE 2 | SITE PLAN
 REF:

CLALLAM CO. PUD #1
 Forks Operations Center
 15-01

INDUSTRIAL CENTER